



## Blind Box

**Blind Box** is used to beat down an obstruction encountered in the tubing string. It is also widely used to cut wireline on a Rope Socket during fishing operations.

Blind Box is approximately nine inches long with a male thread connection and fishneck facing upwards and flat bottom down. The diameter of the Blind Box should normally be matched to the tubing in which it is to be used.

Blind Boxes		
Size Range (in.)	F/N OD (in.)	Connection (in. TPI)
1.25"~1.5"	1.187	15/16-10 UN
1.5"~2.0"	1.375	15/16-10 UN
2.0"~2.5"	1.375	15/16-10 UN
2.5"~3.0"	1.750	1-1/16-10 UN
3.0"~4.0"	1.750	1-1/16-10 UN
4.0"~5.0"	2.313	1-1/16-10 UN
5.0"~6.0"	2.313	1-9/16-10 UN

Other sizes available on request.

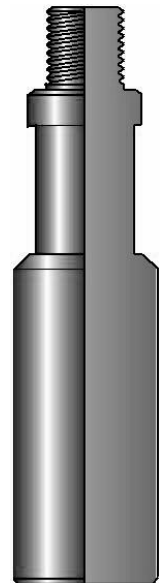

Blind Box

Note : Please specify information below when inquiry

1) Actual OD. of Tool required

2) Connection type

Subject to change without notice